

Village Outreach



Leam Amplifier

Instructions for Use



Introduction

This amplifier has been designed to mix up to 6 separate mono inputs (microphones etc. as well as one stereo input from a CD or tape player).

Village Outreach can also supply microphones (wired, radio, handheld or lapel), and microphone stands if required.

If you have any problems with setting it up which cannot be resolved by reading the instructions on the following pages then please call us on 01588 630097.

If you find any features don't work (e.g. faulty leads or switches) then please tell us when you return the equipment so we can fix them before hiring it out to another customer.

The amplifier is supplied with:

- Two Speakers
- Two Speaker Leads (one longer than the other)
- Two Speaker Tripods
- One Microphone
- One iPod/PC Connection Lead
- Mains Cable

When ordering the system you need to consider if you need a mains extension lead.

We recommend that once you have set up the speakers you get the system working with just a wired microphone before connecting anything else, even if you do not intend to use a microphone. This proves the amplifier and speakers are working and the sound levels are reasonable before adding any other connections.

Connecting Up the System

1. Erect the two speaker stands and mount the speakers on each one. beware, they are heavy and it should be done by two people. The speakers just slot on top of the stands.
2. Connect a speaker cable to each speaker and run it back to the amplifier, one of the speaker cables is longer than the other, the plugs are the same at both ends.

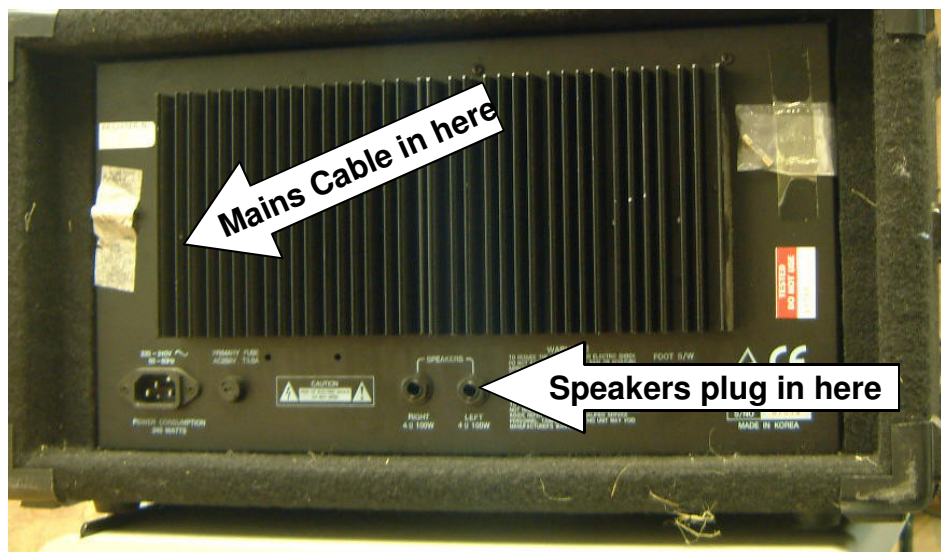

3. The microphone leads can be plugged into any of the six sockets on the front of the amplifier. Make sure the "Level" control (Volume) is turned right down.

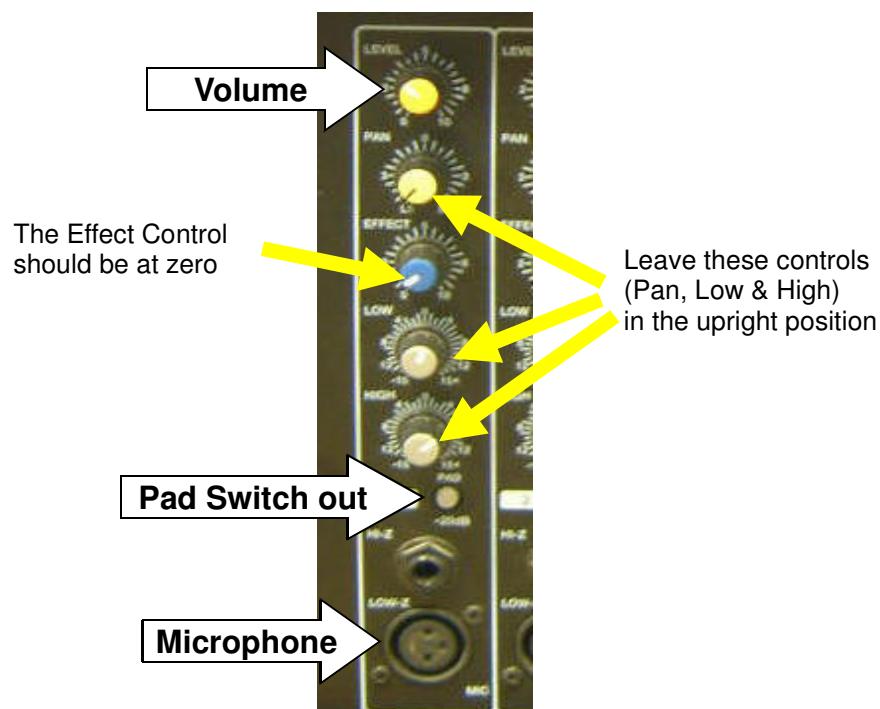

4. Turn the master level controls shown below to about the middle position.

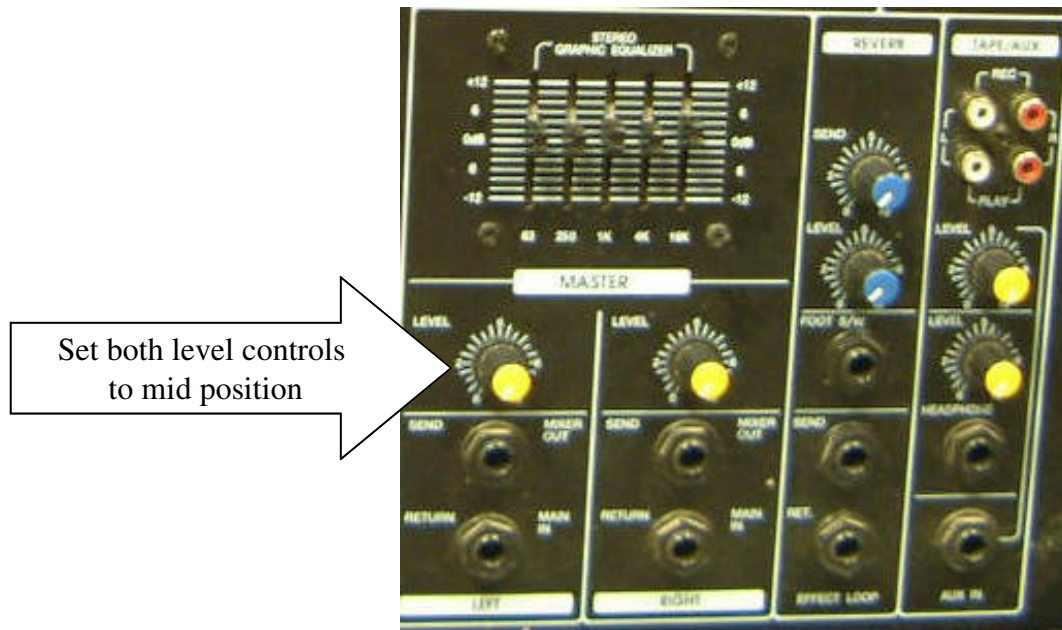

The amp is now ready for use. Switch it on (switch at top right hand corner of the front) and check the red power on light on the front panel comes on.

Ensure the switch on the microphone is on, turn up the microphone volume until you can hear yourself through the speakers.

If you hear a **Loud Screech** this indicates you have the microphone volume too high which induces feedback. Turn down the volume and/or move the microphone so it is not directly in front of a speaker.

Now it is working adjust the master levels so the volume is right for your event, each speaker is controlled from a different control.

More microphones can be plugged in channels 2-6 the volume of each can be independently controlled allowing you to mix different inputs together.

Now you have a basic system up and running you can add other sources as described below.

5. Adding a Tape, iPad or CD Player.

Channels 1-6 are mono, i.e. one source. Channel 7 has two line inputs so you can plug the left and right channels of a stereo system into the amplifier. The lead we provide for iPods has two phono plugs which go in the red and white sockets marked "Play" shown below

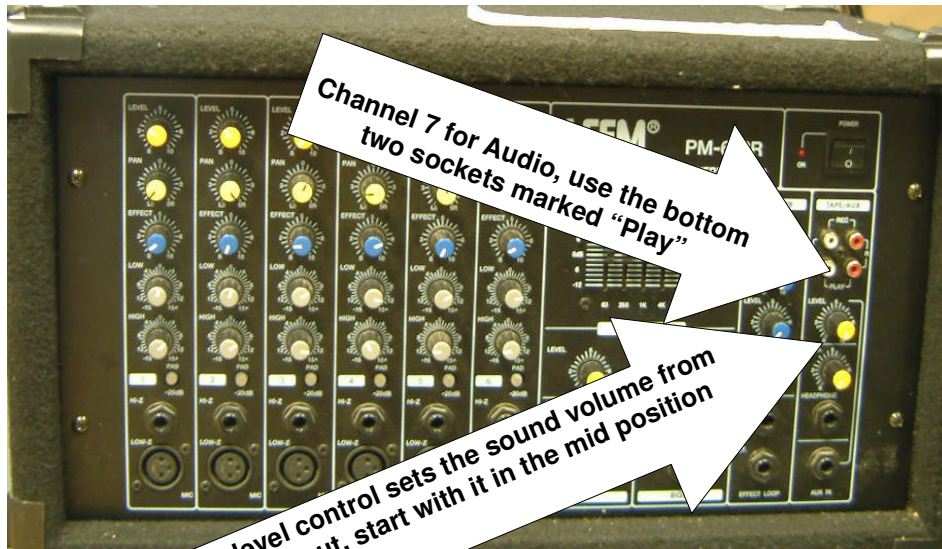

6. Radio Microphone

If you wish to use the radio microphone from Village Outreach the output from the radio receiver should be plugged into a "Line Input" socket.